



Shakmat Tessitura Tailor

• 1U/10HP Eurorack Module

• Built & designed in Belgium

• www.shakmat.com

Installation

The Tessitura Tailor requires a standard 2x5 pin eurorack power cable. Make sure the red stripe on the cable matches the -12V side of the power header. Your module is sold with an Intellijel 1U front panel but can be easily switched to Tiles/Pulp Logic format by swapping the front panel with the provided extra panel. To do so, pop the octave switch's cap and unscrew all the nuts, replace the front panel & screw everything back on.

 **Pulp Logic Power IN** You can power your Tessitura Tailor via a 1U Tile power bus. For this, you need to solder a cable ending with a Futaba J male connector, available in every hobbyist store. The cable has to be soldered on the right way, by respecting the GND & -12V silkscreen on the PCB. If the Pulp Logic power socket is used, cover the eurorack power header with the provided blank connector to prevent short.

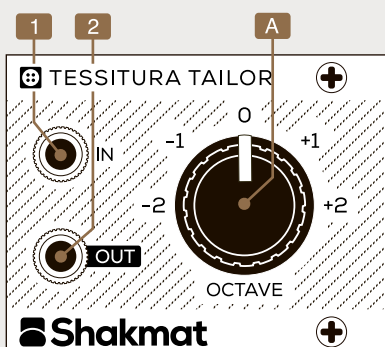

1 CV input

A Octave control

2 CV output

About

The Tessitura Tailor adds or subtracts a precise voltage (from -2 to +2 volts) to the signal received at the CV input. This signal is transposed by octaves, depending on the rotary switch's position. As the CV input is normalised to 0 volt, the module works without any input as an octave switch.

Calibration

Every Tessitura Tailor is carefully calibrated when being produced in our lab. But over time, the transposition can go a little out of tune. To correct this, use a flat head screw driver and turn the trimmer's screw on the back of the module.

Using a mutlimeter, measure the test voltage point reference (marked on the back of the PCB), and adjust the trimmer to obtain a precise value of 5V. You can also calibrate the Tessitura Tailor while sending its output to a well calibrated VCO's V/Oct input. Place the switch in its middle position (0), tune the VCO, place the switch at the +2 position and adjust the trimmer until your VCO is in tune.

 **Voltage reference point**
Use a multimeter here for calibration.

 **Pulp Logic Power IN**
Solder a Futaba J power cable on here.

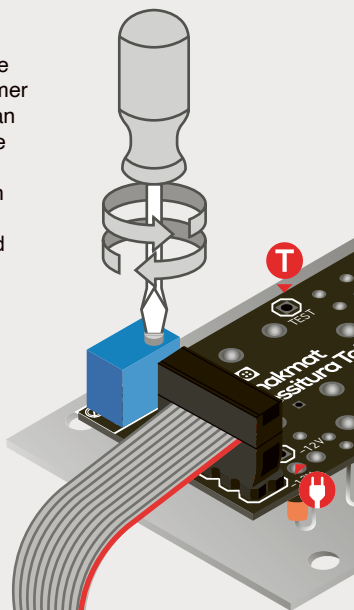

Specifications

Size

10 HP

Depth

22 mm

Current Draw

1 mA @ +12V

1 mA @ -12V

0 mA @ +5V

Input range

-10v to 10v

Output range

-10v to 10v

• www.shakmat.com

 **Shakmat**